

Traverse Rescue™

Engineered For Your Mission

Users' Manual

Titan-Ti Series Basket Stretcher



Model 11-0118 Titan-Ti Tapered
Model 11-0119 Titan-Ti Tapered Split

Traverse Rescue, LLC



Titan-Ti Series Basket Stretcher

Disclaimer

This manual contains general instructions for the use, operation and care of this product. The instructions are not all-inclusive. Safe and proper use of this product is solely at the discretion of the user. Safety information is included as a service to the user. All other measures taken by the user should be within and under consideration of applicable regulations. It is recommended that training on the proper use of this product be provided before using this product in an actual situation.

Retain this manual for future reference. Include it with the product in the event of transfer to new users. Additional free copies are available upon request from Customer Care.

Proprietary Notice

The information disclosed in this manual is the property of Traverse Rescue, LLC., Mississauga, ON Canada. Traverse Rescue, LLC. reserves all patent rights, proprietary design rights, manufacturing rights, reproduction use rights, and sales use rights thereto, and to any article disclosed therein except to the extent those rights are expressly granted to others or where not applicable to vendor proprietary parts.

© Copyright Traverse Rescue, LLC. All Rights Reserved

**Traverse Rescue, LLC.
755 Queensway East, Unit 8
Mississauga, Ontario
Canada L4Y 4C5**

Telephone:905 279 7866

Toll Free (Canada & US):1 866 998 7866

Fax :905 615 1367

Web Site:www.traverserescue.com

Traverse Rescue, LLC manufactures its products under a strict Quality Assurance Program. We also recognize and comply to any applicable standards that apply to each product.

The **CE** symbol on Traverse Rescue products signifies they have been certified in accordance with the Medical Devices Directive 93/42/EEC concerning Class 1 Medical Devices



Made in Canada.

Traverse Rescue, LLC

1.Safety Information

1.1 Warnings

The following are warnings in this manual:



Untrained operators can cause injury or be injured. Permit only trained personnel to operate this stretcher.

Improper use of the stretcher can cause injury. use the stretcher only for the purpose described in this manual

An unrestrained or improperly restrained patient can suffer injuries. Always secure the patient in the stretcher with a restraint system suitable to the situation

Improper operation can cause injury. Operate the stretcher only as described in this manual

An un-attended patient can be injured. Stay with the patient at all times

Helpers can cause injury or be injured. Maintain control of the stretcher and direct all helpers

Improper maintenance can cause injury and damage. Maintain stretcher only as described in this manual

Improper parts and service can cause injury. Use only Traverse-approved parts and service on the stretcher

Modifying the stretcher can cause injury and damage. use the stretcher only as-sold by Traverse.

Attaching improper or inappropriate items to the stretcher can cause injury. Use only Traverse-Approved items on the stretcher

1.2 Important

Boxes like the one below emphasize important information.

Important

Rescue procedures using ropes, harnesses, bridles and other Personal Protective Equipment require special skills and are potentially hazardous activities. No rescue personnel should attempt such rescue procedures unless he or she has received professional instruction and training

1.3 Bloodborne Disease Notice

OSHA (Occupational Safety and Health Administration) requires employers to protect workers from workplace exposure to bloodborne diseases such as HIV-1 and hepatitis. To reduce the risk of exposure when using the stretcher, follow disinfecting and cleaning instructions in this manual.

1.4 Safety Labels

Labels place important information from the Users' Manual on the stretchers.

Read and follow label instructions. Replace worn or damaged labels immediately. New labels are available from Traverse.



Load Limit - 1134 kg / 2500 lb
 Read and Understand the Manual Before Use
www.traverserescue.com

The Load-Limit label shown is affixed to the stretcher.

2. Operator Skills and Training

2.1 Skills

Operators using the stretcher need:

- A working knowledge of emergency patient-handling procedures.
- The ability to assist the patient
- A complete understanding of the procedures described in this manual

2.2 Training

Trainees need to:

- Follow a training program designed or approved by their training officer
- read this manual. For additional free users' manuals, contact Traverse Customer Care.
- Practice with the stretcher before using it in regular service

- be tested on their understanding of the stretcher
- record their training information

3. About The Stretcher

3.1 General Specifications

Polyethylene Netting...-65°F/-54°C to +200°F/+93°C

Restraint Webbing
 Tensile Strength.....975 lbs. / 442 kg
 Restraint Buckles
 Minimum Tensile Load.....4000 lbs. / 1814 kg
 Buckles meet ANSI Z359.1 and CSA Z259.1

! WARNING

Untrained Operators can cause injury or be injured. Permit only trained personnel to operate the stretcher.

Important

Rescue procedures using ropes, harnesses, bridles and other Personal Protective Equipment require special skills and are potentially hazardous activities. No rescue personnel should attempt such rescue procedures unless he or she has received professional instruction and training

Length	83"	211 cm
Width - Non Split	23"	58 cm
Width - Split	23.5"	60 cm
Depth	7.25"	18 cm
Weight (non-split)	13 lbs	6 kg
Weight (Split-Apart)	17 lbs	8 kg
Rated Load Limit	2500 lbs	11 kN

Traverse reserves the right to change specifications with out notice.

4. Restraints

4.1 About the Restraints

A total of four restraints are included with your purchase of this stretcher.

These restraints are to supplement what you will typically use to tie-in a patient in a high-angle situation. We have made them to a suitable strength in order to compliment your own system of tubular webbing, cord or the like. These restraints are only for

securing the patient into the stretcher, and are not to be used for lifting or for any other purpose.

4.2 Fastening and Tightening the Restraints

The strap with the three-bar buckle is constructed with a looped end that attaches to the stretcher, and a free end that is used to tighten the restraint (figure 1).

- 1 Pass the three-bar buckle and webbing upward through the opening in the two-bar buckle (fig. 2). Make sure to pull the free end of the webbing completely through the opening
- 2 Pull slightly on the free end of the webbing to firmly seat the three-bar buckle on top of the two-bar buckle (fig. 3).
- 3 Tighten the restraint by pulling on the free end of the webbing.

4.3 Loosening and unfastening the Restraints

To loosen a restraint, pull the breakaway tab toward the buckle (fig. 4). Continue pulling until the restraint is as loose as desired.

To unfasten the restraint, first loosen as in step number 1, then angle the three-bar buckle and pass it downward through the opening in the two-bar buckle (fig. 5).

4.4 Attaching the Restraints

The top edge of the Durathene® netting is shaped with coves to provide points where restraints can easily be fastened to the lower-rail of the stretcher (fig. 6).

Select attachment points that are appropriate for effective securing of the patient, as well as for working together with your own fastening system.

Attach the supplied restraints as follows:

1. Unfasten the buckle to separate the restraint straps.
2. Starting outside the stretcher, pass the looped end of the strap inward between the stretcher rail and the netting at a chosen attachment point.
3. Thread the buckle through the restraint loop (Fig. 8) and pull until the loop is tight around the stretcher rail.
4. Attach the remaining strap to the opposite side of the stretcher following steps 2 and 3.

5. Using the Stretcher

5.1 Before Placing the Stretcher in Service

- Personnel who will work with this stretcher need to read this manual.
- If using the supplied restraints, attach them as instructed in *Attaching the Restraints*.
- Confirm that the stretcher, restraints and mesh netting are in good condition. Follow instructions in *Inspecting the Stretcher* in this manual.

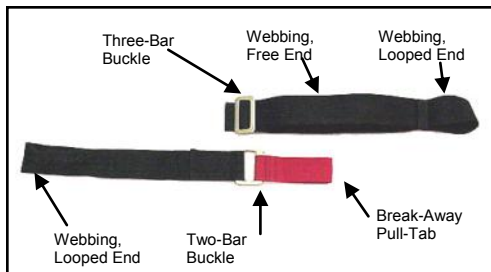

Figure 1, Components

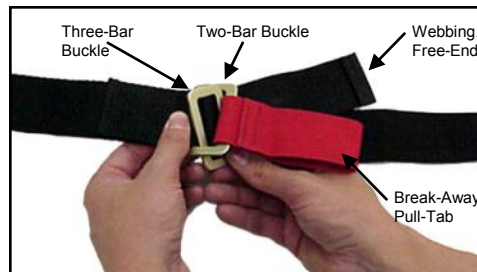

Figure 2, Fastening the Buckle

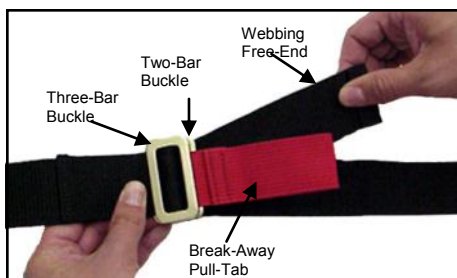

Figure 3, Seating the Buckles

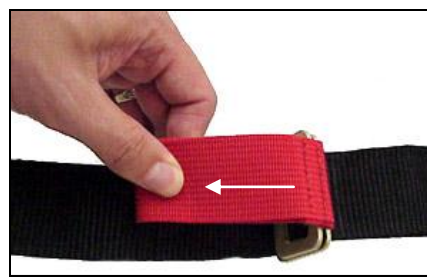

Figure 4, Loosening Restraint

5.2 General Guidelines for Use

- Using the stretcher requires a minimum of two trained operators. In most situations, operators will want or need additional help. For information about placement and direction of helpers, see *Carrying the Stretcher* in this manual.
- Follow standard emergency patient-handling procedures when using the stretcher.
- Stay with the patient at all times.

! WARNING

An unrestrained or improperly restrained patient can suffer injuries. Always secure the patient in the stretcher with a restraint system suitable to the rescue operation.



Figure 5, Unfastening Buckle



Figure 6, Restraint Cove

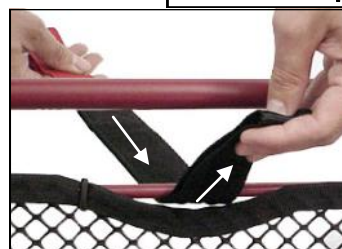

Figure 7, Passing Looped End



Figure 8, Threading Buckle

- Always use the patient restraints provided, as well as a supplementary restraining system as per your training and team protocols, and the situation.
- Personnel using the stretcher in high-angle environments are responsible for learning the proper techniques involved, and for selecting the equipment and procedures best suited to the rescue situation.

5.3 Carrying the Stretcher

Carrying the stretcher requires a minimum of two operators. Additional personnel will be helpful or even needed in most situations. Use an even number of personnel and position them to keep the stretcher as even as possible.

Using Additional Help

Operators should maintain control of the stretcher and direct any helpers.

5.4 Sliding the Stretcher

Slide the stretcher on its runners over smooth surfaces. Avoid rock, stumps, branches or other hazards that could penetrate the netting, or cause discomfort or injury to the patient.

5.5 Transporting the Stretcher on a Cot

Use the cot restraints to secure the stretcher to the cot.

5.6 Using High-Angle Rescue Procedures

High angle and rope-access rescue can involve any combination of ropes, winches, pulleys, litter bridles, belay devices and many other specialized items and devices too numerous to mention. Proper and safe use of these tools requires professional instruction and training.

When using high-angle or rope-access equipment with the stretcher, ensure the equipment has an adequate load-rating, and that it is at least as great as that of the stretcher.

During a high-angle rescue, the stretcher may be oriented vertically, horizontally or in other positions. Secure the patient in the stretcher so that he/she does not slip in any direction, or be able to accidentally come out of the stretcher.

Tie-In Points

The Stretcher has several Tie-In points where carabiners or ropes may be attached to the upper rail. As an option, this stretcher has incorporated into it a patent SträtLoad™ feature which allows for dedicated attachment points when being rigged with a four-point litter-bridle for a horizontal raise or lower.

5.7 Using Split-Apart Feature

The Traverse Split-Apart stretchers offer very fast assembly time, and there are no pins to place etc. Before starting, be sure to clean all parts of dirt, mud, snow etc. To assemble:

1. Face the two open parts of stretcher toward each other
2. Lift the open ends simultaneously to about a 30° angle, and slide the two parts together, interlocking all of the teeth of the Bottom Connectors.
3. Lower the now-inter-locked parts to the floor
4. Ensure Upper Connector parts mate
5. Turn Collets onto the opposing threaded parts of the Upper Connectors. Ensure these Collets are snug, and that there are no threads showing.

To disassemble, simply reverse the above sequence

Please Note: It is imperative that throughout the operation of this stretcher during a rescue or in practice, that you check the integrity of the connection. If you see threads on the Upper Connector, re-tighten the collets.

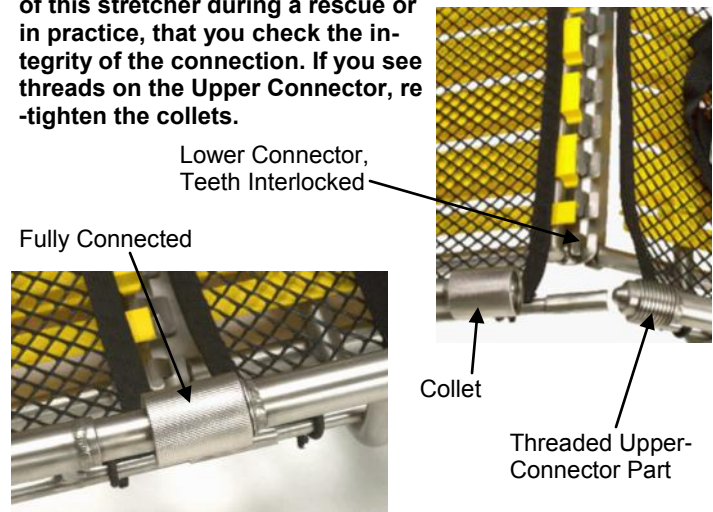

Important
 Personnel using the stretcher in high-angle rescue situations are responsible for knowing the techniques involved and for selecting the equipment and procedures best suited to each rescue situation

! WARNING
 Improper operation can cause injury. Operate the stretcher only as described in this manual.

! WARNING
 An unattended patient can be injured. Stay with the patient at all times.

! WARNING
 An unrestrained or improperly restrained patient can suffer injuries. Always secure the patient in the stretcher with a restraint system suitable to the rescue operation.



6. Maintaining The Stretcher

6.1 Maintenance Schedule

The stretcher requires regular maintenance. Set up and follow a maintenance schedule, such as provided by the form below. This form represents minimum maintenance, and you can modify your own program based on your needs.

	Each Use	As Needed	Each Month
Disinfecting (See 6.3)	•		
Cleaning (See 6.3)		•	
Inspecting (See 6.4)		•	•

When using maintenance products, follow the manufacturers' directions and read the manufacturers' material safety data sheets.

6.2 Disinfecting and Cleaning the Restraints

1. Remove restraints from stretcher.
2. Buckle restraints before cleaning. This helps prevent damage to buckles or washing machine.
3. Place buckled restraints inside a mesh bag (not supplied) and place in an industrial washing machine.
4. Launder restraints in warm water, using a disinfectant soap and gentle agitation. Do **not** use bleach.
5. Remove restraints from mesh bag and hang to dry. Do **not** put restraints into home or commercial dryer.
6. Attach clean, dry restraints to stretcher as instructed in Section 4.

6.3 Disinfecting and Cleaning the Stretcher

Wipe or spray all surfaces of stretcher and netting with disinfectant. Follow disinfectant manufacturers' directions.

Traverse recommends inspecting the stretcher for obvious damage as you disinfect it.

Hand clean the stretcher and netting with a mild detergent in warm water. Rinse well, and dry with a towel.

6.4 Inspecting the Stretcher

Have your stations/services' maintenance personnel check the following:

- ◆ All components should be present
- ◆ Weld joints should be free of cracks or any other sign of breakage
- ◆ Stretcher frame (top and lower rails, runners, ribs) should be free of dents, cracks or un-intentional bends
- ◆ Polyethylene netting should be free of breaks and tears, and should be securely fastened to the lower rail.
- ◆ Blue back support should be securely fastened into place
- ◆ Warning labels should be clear and legible for all users to see and read.
- ◆ Restraint webbing should be in good condition with no cuts or frays
- ◆ Restraint buckles should be free of visible damage, and should operate properly.

If inspection shows damage or excessive wear, remove the stretcher from service until appropriate repairs are completed (see Repair, Parts and Service, Section 7).

6.5 Storing the Stretcher

Store the stretcher in a dry area. Make sure the stretcher is clean and dry before placing it into storage.



WARNING

Improper maintenance can cause injury. Maintain the stretcher only as described in this manual.

Important

Disinfectants and cleaners containing bleach, phenolics, or iodines can cause damage to the restraints and stretcher. Disinfect and clean only with products that do not contain these chemicals.

7. Repair, Parts and Service

If your stretcher is showing excessive wear or cracks (either in the material or at welds), it is time to retire it from service. **Do not** attempt to repair or replace any metal component or weld.

If the Mesh Liner, the Back Support, Patient Restraint straps or any labels are damaged and need repair, please call your Dealer or us to have them replaced.

See the table below for further description

<u>Part Number</u>	<u>Description</u>
05-0102	Full Back Support
05-0104	Split Back Support, Tapered
05-0114	Mesh, Titan Tapered
05-0115	Mesh, Titan Split Tapered
04-0108	Restraint Strap
08-0102	Load-Limit Label

Accessories

Traverse offers a full line of accessories that are approved for use with the Titan Series stretchers.

Always follow the instructions packaged with accessories. Keep the instructions with this manual. Be aware of any special considerations (loading heights, door heights, etc.)

Traverse Rescue, LLC (Traverse) Limited Warranty states that all Traverse products are warranted for a period of one year after the date of invoice, to the original purchaser. This warranty is provided against any material or workmanship flaws or defects. In the event of such a flaw or defect during this warranty period, please contact Traverse Rescue immediately. Traverse agrees to repair or replace (at our choice) the defective product. Our Limited Warranty does not cover damage due to abuse, misuse, lack of care, improper use or accidents. It also does not cover damage due to attempted repair by the pur-

<u>Part Number</u>	<u>Description</u>
11-0110	Mule Litter Wheel
04-0180	Traverse Restraint Strap
17-0101	Millennia Backboard
17-0100	Universal Head Immobilizer
17-0105	Quick-Connect Restraint Straps
17-0110	Fastrap Restraint System

Related Products

<u>Part Number</u>	<u>Description</u>
16-0100	540°™ Rescue Belay-Large
16-0200	540°™ Rescue Belay-Small
11-0100	Titan Tapered Stretcher, SS
11-0104	Titan Split-Tapered Stretcher, SS
42-000-000	UT2000 Series Backcountry Stretcher
19-0100	Traverse Rescue Stretcher

8. Limited Warranty

chaser that was not authorized by Traverse. No other warranties exist or are implied by Traverse. This limited warranty excludes, and Traverse shall not be held liable for any punitive, incidental, special or exemplary damages arising out of the breach of the warranty on sales by Traverse or otherwise, or through the performance or non-performance of any third-party part, product, service or system. This limited warranty does not limit in any way, nor alter in any way, other manufacturer's warranties on products that are sold by Traverse.

9. Traverse Customer Care

Customer Care and product support are important aspects of each Traverse product.

For assistance with this, or any other Traverse product, please contact Traverse Customer Care.

Please have the serial number of your Traverse stretcher available when calling Traverse Customer Care, and include this number with any written communications.

Traverse Rescue, LLC.
 755 Queensway East, Unit 8
 Mississauga, Ontario
 Canada L4Y 4C5

Telephone:905 279 7866

Toll Free (Canada & US):1 866 998 7866

Fax :905 615 1367

Email: info@traverserescue.com

Web site: www.traverserescue.com



Training Schedule

Date	Name	Training Method

Maintenance Record

Date	Maintenance Performed	By