



Vertical 561-V locking clamp system for SCOOP EXL stretcher

Rel.121215
English (UK)



*Read this manual
carefully and keep it
for future reference.*

Ferno Technical Support

Customer Service and Technical Support are important aspects of every Ferno product. Before contacting us, note the serial number of the product and specify it in all written communications. For all queries concerning technical support, contact Ferno Washington Italia s.r.l.:

Telephone (toll-free, Italy only)	800 501 711
Fax	+39 0516861508
Email	info@ferno.it

Ferno Customer Service

For assistance and further information, contact Ferno Washington Italia s.r.l.'s Customer Services:

MANUFACTURER

Ferno Washington Italia s.r.l., Via Benedetto Zallone 26
40066 - Pieve di Cento (BO) - ITALY

Telephone (toll-free in Italy)	800 501 711
Phone	+39 0516860028
Fax	+39 0516861508
Website	www.ferno.it

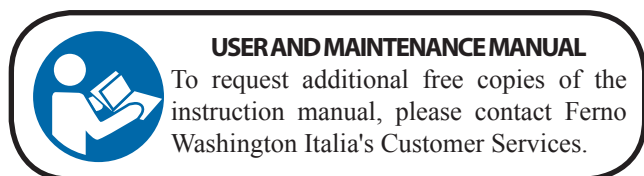

Limitation of Liability

This manual contains general instructions on the use and maintenance of the product. The instructions do not cover all possible applications and operations. The user is solely responsible for proper and safe use of the product. The safety information is provided as a service to the user and ensures only the minimum required level of safety to prevent injury to operators and patients. Any other safety measure implemented by the user must comply with applicable regulations. Before using the product, it is strongly recommended that staff be trained in its correct usage. Retain this manual for future reference. In case of change of ownership, ensure that the manual remains with the product. Additional free copies can be obtained from Ferno Washington Italia's Customer Services.

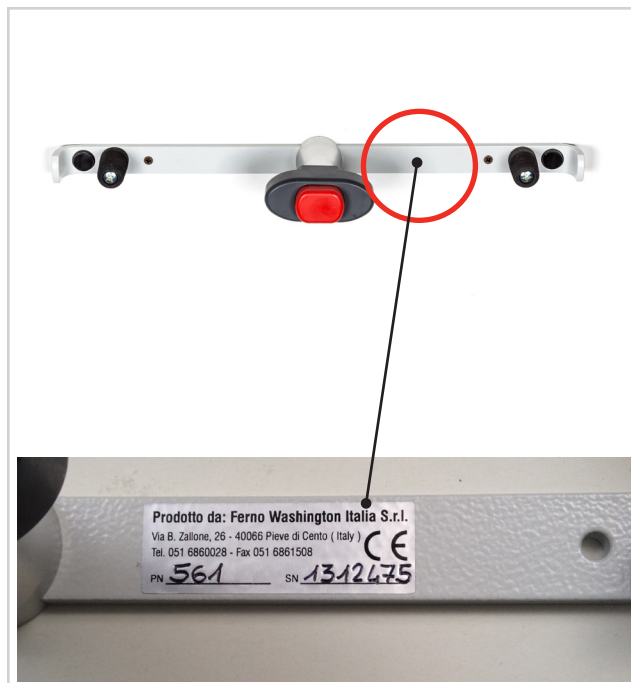

Serial number 561-V _____

Location: Main label positioned on the right bar of the clamp.

Intellectual Property Declaration

The information in this manual is the property of Ferno Washington Italia s.r.l. of Via Benedetto Zallone 26, 40066 Pieve di Cento (BO), Italy.

All patent rights, design rights, construction, reproduction, use and sale relating to any item covered in this manual are the confidential and exclusive property of Ferno Washington Italia s.r.l., except for rights expressly transferred to third parties or not attributable to parties owned by the supplier. It is prohibited to reproduce this manual, either in full or in part, without the prior consent of Ferno Washington Italia s.r.l..

Limited Warranty

Ferno products are covered by a 24-month warranty against manufacturing defects. For the full terms and conditions of warranty and liability, see the *Warranty* chapter on page 11.

CONTENTS

Chapter/Section	Page	Chapter/Section	Page
Ferno Technical Support _____	2	4.4 How to remove the stretcher _____	9
Ferno Customer Services _____	2	5 - Maintenance _____	10
1 - Safety Information _____	4	5.1 Routine maintenance _____	10
1.1 Warning _____	4	5.2 Disinfection _____	10
1.2 Important _____	4	5.3 Cleaning _____	10
1.3 Blood-borne diseases _____	4	5.4 Inspection _____	10
1.4 Load capacity _____	4	6 - Technical Support _____	11
1.5 Compatibility _____	4	6.1 Technical Support Service _____	11
1.5 Symbol glossary _____	4	7 - Warranty _____	11
1.6 Information and safety labels _____	5	7.1 Warranty Terms & Conditions _____	11
2 - Clamping _____	5	7.2 Limitations of liability _____	12
2.1 Description _____	5	7.3 Warranty Claims _____	12
2.2 CE Conformity _____	5	7.4 Complaints _____	12
2.3 Components (Clamp) _____	6	7.5 Returns authorization _____	12
3 - Installation _____	7		
3.1 Installing the clamp _____	7		
4 - Usage _____	8		
4.1 Clamping handle _____	8		
4.2 Support hooks _____	8		
4.3 How to attach the stretcher _____	8		

1 - SAFETY INFORMATION

Read the user manual carefully. The manual is an integral part of the device and must always be kept on hand. For your own personal safety and that of your patients, please note the following:

- Prior to each use, perform an inspection ensuring that there are no signs of wear, damage, or malfunction. Refer to section 5.4, *Inspection*, page 10.
- To prevent infection and / or bacterial contamination, refer to the information in sections 5.2 and 5.3, *Disinfection* and *Cleaning*, page 10.

1.1 Caution

The danger symbols draw attention to potentially dangerous situations that, if ignored, may result in accidents, damage and/or injury.



WARNING

Improper use of the device may cause damage and / or injury. Install and use the device as described in this manual.

Unauthorised modification of the device may cause serious damage, injury and/or unforeseeable operational problems. Do not modify or alter the device in any way.

Any damage to the components of the device, or the entire unit, can alter its performance and safety. Inspect the device frequently, especially before and after each use. Place the device out of service if it shows signs of wear or damage.

Improper maintenance may cause serious accidents, injuries and/or damage. Perform maintenance as instructed in this user manual.

The use of improper or unauthorised devices may cause accidents, damage and/or injury. Use only devices that have been approved and authorised by Ferno Washington Italia.

Unauthorised repairs, and repairs carried out by people not approved by Ferno Washington Italia, will render all warranties null and void and may compromise the safety of the device.

Non-original spare parts and inadequate repairs may cause damage and/or injury. Use original Ferno parts exclusively, and only contact Ferno Washington Italia's Customer Support.

1.3 Blood-borne diseases

To reduce the risk of exposure to infectious diseases that may be transmitted by blood, such as HIV-1 or Hepatitis, follow the instructions on disinfection and cleaning in this manual carefully.

1.4 Compatibility

The 561-V Clamp is specifically designed to allow the SCOOP EXL atraumatic stretcher to be stowed in an ambulance.

Any other configuration is incompatible with the specifications and the instructions presented in this manual. Ferno Washington Italia is not liable for damages caused to users or third parties arising from improper use of the 561-V Clamp.

1.5 Glossary of symbols

The symbols used in this manual and / or on the trolley's labels are defined below. The CE mark is present on the device and in this manual.



Read the user manual carefully



This product meets European Union Standards



QR Code



Do not lubricate.

1.2 Important

Boxes labelled "Important" contain important information on use and/or maintenance of the device.

Important

1.6 Information and safety labels

The information and safety labels contain important information that the user needs to know.

Read and follow label instructions. Replace worn or damaged labels immediately. To obtain replacement labels contact Ferno Washington Italia's Customer Services (page 2). The label shown below is applied to the device.



Main label

2 - THE CLAMP

2.1 Description

The 561-V clamp is a device for fixing the SCOOP EXL stretcher vertically to the interior wall of an ambulance.

It was designed specifically for use with the SCOOP EXL stretcher.

The clamp system comprises two rods:

1. an upper bar provided with a locking handle,
2. a lower bar provided with two support hooks.

Both bars are designed to be installed using four 6 mm. diameter screws with cylindrical heads (*screws not supplied*).

2.2 CE conformity

MEDICAL DEVICES DIRECTIVE



Ferno's products meet the requirements of European Directive 93/42/EEC concerning medical devices. The clamp belongs to Class I.

The clamp has been tested according to EN 1789.

For further information: info@ferno.it

CLAMP COMPONENTS

- Top bar
- Locking handle
- Bottom bar
- Support hooks



WARNING

Improper use of the device may cause damage and / or injury. Use the 561-V clamp only as described in this manual.

2.3 Components (Clamp)

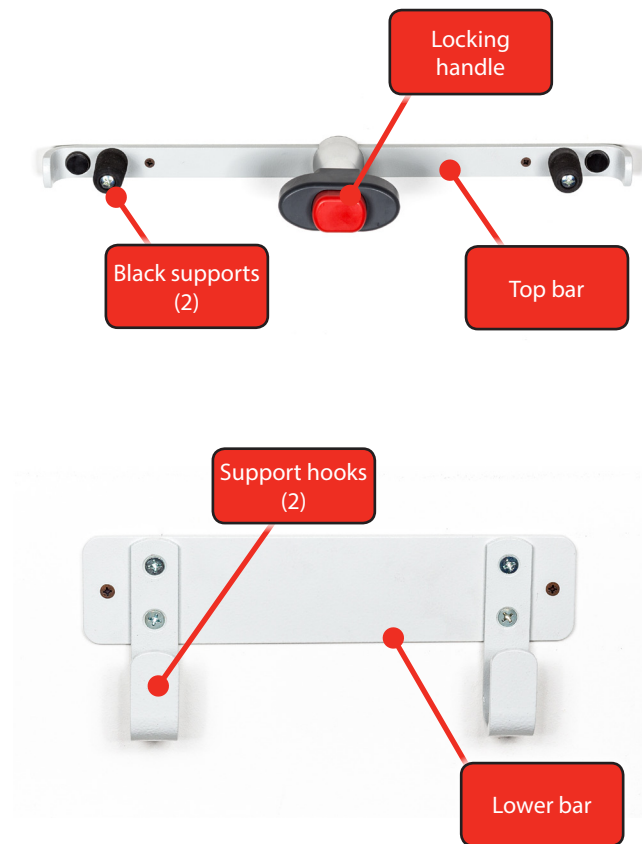

3 - INSTALLATION

3.1 Installing the clamp

To install the clamp, proceed as follows:

1. Locate an accessible location inside the ambulance for the installation of the clamp. Choose a flat surface on which to securely install the clamp.
2. Place the head end of the stretcher into the hooks of the lower bar (Figure 1). Ensure the stretcher is positioned with the front side facing the mounting surface and the back facing out (Figure 3).
3. Position and secure the upper bar of the device with both black supports (right and left) at about 1 cm from the lower end of the last two handles (right and left) of the body section (Figure 2).
4. Place the bars and the SCOOP EXL stretcher on the mounting surface.

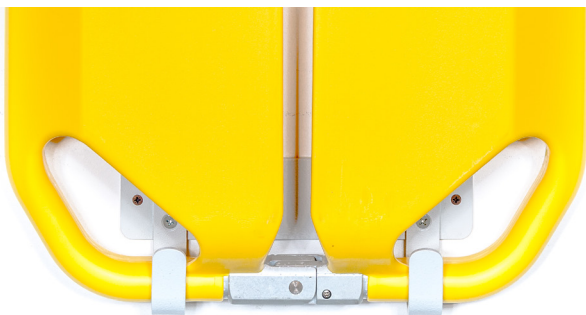

Figure 1 - Positioning the stretcher's head end in the bottom bar



Figure 2 - Positioning the top bar

5. Before proceeding with the installation, ensure the bars, both upper and lower, are positioned horizontally and that the stretcher is locked vertically. Mark the position of the bars through the mounting holes.
6. Remove the bars and the stretcher.
7. Drill 6.5 mm diameter holes in the installation points.
8. Fix the bars using 6 mm diameter screws (*not supplied as standard*).



Figure 3 - Clamp installed and holding SCOOP EXL stretcher

4 - USAGE

4.1 Locking handle

The upper bar is fitted with a locking handle, which locks and unlocks the stretcher.

- **TO UNLOCK THE HANDLE:** Press the red button and simultaneously turn the handle clockwise until it is in the vertical (open) position (Figure 4).
- **TO LOCK THE HANDLE:** Turn it counterclockwise until it reaches the horizontal (closed) position. When correctly locked, a click is felt and the red button returns to the initial position.



Figure 4 - Unlock the handle

4.2 Support hooks

The lower bar is fitted with two support hooks. These hooks are required to support the head end of the stretcher's main body (Figure 5).

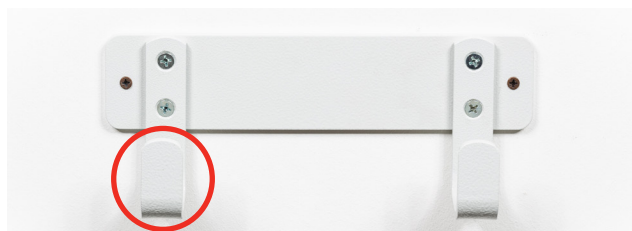

Figure 5 - Lower bar support hooks

4.3 How to clamp the stretcher

To correctly clamp the stretcher to the device:

1. Press the locking handle's red button on the top bar.
2. While pressing the button, turn the handle clockwise to the vertical (open) position.
3. Place the end of the head-end of the stretcher's main body into the hooks of the bottom bar (Figure 6). Ensure the stretcher is positioned with the front side facing the mounting surface and the back facing out (Figure 3).

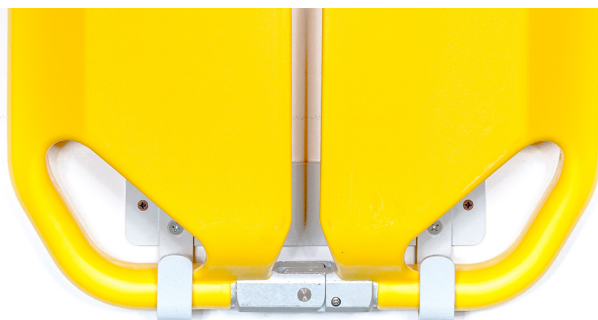

Figure 6 - Positioning the head end into the hooks

4. Bring the stretcher in contact with the upper bar (Figure 7) in such a way that the black supports are inserted into the two end handles of the body section (Figure 8).
5. Turn the handle counterclockwise and lock it in the horizontal position (Figure 8).
6. Ensure the stretcher is correctly clamped in place, that the stretcher locking levers are in the closed position, and that the locking handle is in the horizontal position.



Figure 7 - Positioning the top bar

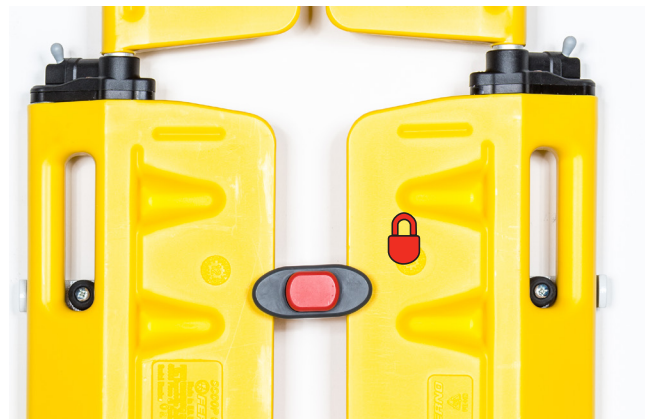

Figure 8 - Handle locked in horizontal position (closed)

4.4 How to remove the stretcher

To remove the stretcher from the clamp:

1. Press the locking handle's red button on the top bar (Figure 9).
2. While pressing the button, turn the handle clockwise (Figure 9) to the vertical (open) position.
3. Lift the stretcher and remove it from the lower bar's support hooks (Figure 10).



Figure 9 - Rotating the handle clockwise



Figure 10 - Extraction of the stretcher from the clamp

5 - MAINTENANCE

5.1 Routine maintenance

The clamp requires regular maintenance. It is recommended to perform preventive maintenance on the device once a year. The table to the right shows the minimum maintenance schedule. Repairs must be performed by Ferno's qualified personnel, using original spare parts.

If there are signs of wear and damage, discontinue use of the device and immediately contact Ferno's Technical Support Service.

Maintenance Intervals	After each use	Whenever necessary	Every month
Disinfection (page 10)		•	
Cleaning (page 10)		•	•
Inspection (page 10)	•	•	•

5.2 Disinfection

1. Clean the clamping surfaces with a disinfectant suitable for non-abrasive surfaces.
2. Do not immerse the clamp directly in disinfectant.
3. During disinfection, ensure there are no signs of wear and/or damage.
4. Dry with a cloth. Ensure all the components of the device are completely dry before reusing them.

It is advisable to wear suitable gloves (e.g. household or disposable gloves) during disinfection.

5.3 Cleaning

1. Clean the surface of the clamp using a cloth and warm soapy water or a mild solvent.
2. Dry with a cloth.

Do not wash with high pressure water

It is advisable to wear suitable gloves (e.g. household or disposable gloves) during disinfection.

5.4 Inspection

To ensure optimal use of the device, it is important to keep all the components in good condition and to remove all traces of dirt, debris and bodily fluids. When not in use, the device must be stored in an dry, indoor environment and must be inspected at least once a month.

Inspect the locking system and ensure there are no broken or bent parts, or missing, worn or damaged parts / components. If any signs of wear or damage are found during inspection, discontinue use of the device immediately and contact Ferno's Technical Support Service to request repairs/maintenance. Refer to Chapter 6 *Technical Support*, page 11.



WARNING

Improper maintenance may cause serious accidents, injuries and/or damage. Perform maintenance as instructed in this user manual.

Important

When not in use, store the device in an indoor environment that is dry and protected from direct sunlight.

Important

The use of products containing chlorine, phenols, or iodine may harm the product. Do not use products containing these agents for cleaning/disinfection.

Important

After disinfection/cleaning, ensure the stretcher and its components are fully and completely dry before use.

Important



DO NOT LUBRICATE THE CLAMP

The 561-V clamp requires no lubrication; **DO NOT** lubricate the clamp.

Important

DO NOT WASH WITH HIGH PRESSURE WATER



Do not use high pressure water to clean the device.

6 - TECHNICAL SUPPORT

6.1 Technical Support Service

For technical support concerning our products, please contact Ferno Washington Italia's Technical Support Service.

Telephone (toll-free, Italy only)	800 501 711
Phone	+39 0516860028
Fax	+39 0516861508
Email	info@ferno.it
Website	www.ferno.it

For information on use of the Ferno device, and to schedule training courses on correct use of the device, contact Ferno Washington Italia's Customer Service.



WARNING

Non-original spare parts and inadequate repairs may cause damage and/or injury. Use only Ferno original parts and contact only Ferno Washington Italia's Customer Support.



WARNING

Unauthorised modification of the device may cause serious damage, injury and/or unforeseeable operational problems. Do not modify or alter the device in any way.

7- WARRANTY

7.1 Warranty Terms & Conditions

Ferno's products are guaranteed against manufacturing defects for a period of 24 months from the date on the Ferno Washington Italia s.r.l. shipping document.

Ferno Washington Italia guarantees its replacement parts for a period of 12 months.

During the warranty period, Ferno will repair and/or replace any parts found to have manufacturing defects, excluding the costs of: manual labour, travel, transport, and packaging.

The warranty does not cover consumables or parts prone to wear and tear due to normal use of the product, all parts typically subjected to sliding or rolling friction (bearings, brushes, lubricants, shoes, tracks, etc.), parts potentially exposed to oxidation or corrosion (copper or metal alloy contacts, mechanical equipment), or batteries. The surface finishes (gelcoat/resin, paint, powder paint, decals, tape, printing, etc.) are guaranteed for 90 days.

Repairs are performed by trained technical staff at the Washington Ferno Italia s.r.l. site in Via Zallone 26- 40066 Pieve di Cento (BO), or at the Customer's premises if suitable arrangements with Ferno Washington Italia's Customer Services have been made. Technical support at the Customer's premises must be arranged beforehand and involves a refund of costs incurred and documented on request. For information on the costs of technical interventions, contact the relevant office at Ferno Washington Italia s.r.l.

Repairs are guaranteed for 6 months from the date of repair. This warranty applies only when the product is used according to the instructions in the user manual provided. Misuse and negligence invalidates this warranty.

The warranty is valid from the day the product is shipped

from Ferno Washington Italia s.r.l., and the shipping rates are not covered by this warranty. Ferno Washington Italia s.r.l. is not liable for damages sustained during shipment or due to misuse of the product.

Products sold by Ferno Washington Italia s.r.l. that do not bear the Ferno trademark are covered by the warranty of the original manufacturer. Ferno Washington Italia s.r.l. does not extend the periods of warranties of other manufacturers; Ferno Washington Italia s.r.l. assumes no responsibility for products manufactured by others.

The warranty is rendered null and void in the case of:

- Failure to observe the instructions on use,
- Misuse,
- Inappropriate use or handling,
- Repairs by non-authorised persons,
- Damage during transport due to improper packaging of items returned by the user,
- Inadequate maintenance,
- Failure to use original spare parts.

In cases not covered by the warranty, Ferno Washington Italia does not bear the transport costs for sending or returning the product.

7.2 Limitation of liability

If a product is found to be defective, Ferno Washington Italia s.r.l. will repair and replace it, or, at its own discretion, refund the purchase price. Under no circumstances can Ferno Washington Italia s.r.l. be held liable for more than the sale price of the product. The buyer accepts these conditions for all types of damage. Ferno Washington Italia s.r.l. does not offer other warranties, either express or implied, nor any implied warranties of merchantability or fitness for a particular purpose for its own products, or those manufactured

by others. In case of infringement of the limited warranty, any legal actions must be filed within one year from the date on which the infringement was, or should have been, discovered. Ferno Washington Italia s.r.l. reserves the right to terminate the warranty of the products sold:

- If the labels or plates bearing the manufacturer's logo and/or the serial or registration number are rendered illegible or removed;
- If the product has undergone modifications, repairs or treatment unauthorized by Ferno Washington Italia, and/or by personnel not authorized by Ferno Washington Italia;
- If the product is not used in compliance with the instructions, or for purposes other than those for which it was designed.
- as indicated in section 7.1, "Warranty Terms & Conditions".

Ferno Washington Italia s.r.l. cannot, in any event, be held liable for direct or indirect damage due to usage that is non-compliant with the instructions in the user manual or the intended purpose of the product.

7.3 Liability for defects

Contact Ferno's Customer Service immediately if you receive a product that is suspected to be defective. A representative will assist the customer through the complaints procedure. Before returning a product to Ferno Washington Italia s.r.l., contact Ferno's Customer Service to request authorisation.

7.4 Complaints

Any complaints must be communicated to the reseller, or to Ferno Washington Italia s.r.l.'s Customer Service, within 5 days of receipt of the product or of discovery of the alleged defect.

Claims or disputes regarding a single product does not release the buyer from the obligation to collect and pay for other products in the order, unless otherwise agreed with the seller.

7.5 Return Authorization

No product will be accepted without the prior approval of Ferno Washington Italia s.r.l..

Products returned for business reasons, or for reasons not relating to lack of conformity of the product, will be accepted only after verification of their condition by Ferno Washington Italia s.r.l. qualified personnel.

Product User and Maintenance Manual, required to operate the product safely, maintain its efficiency and reliability, and ensure the validity of the warranty.

Rel.121215
English (UK)

Ferno Washington Italia s.r.l.

Via Benedetto Zallone 26

40066 - Pieve di Cento (BO) - ITALY

Telephone (toll-free in Italy)	800 501 711
Phone	+39 0516860028
Fax	+39 0516861508
E-mail	info@ferno.it
Website	www.ferno.it